

Profile Data

Piston Seal PS08B

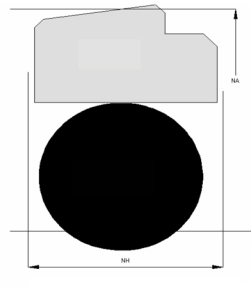

Function

Piston seals are designed to seal the pressurized hydraulic fluid against the atmosphere or between two pressurized spaces.

Features

- ⇒ Asymmetrical, single acting piston seal, designed with interference of the O-Ring on the ID and slight interference of the PTFE glide ring on the OD.
- ⇒ Excellent sealing performance in low and high speeds.
- ⇒ Suitable for positioning functions.
- ⇒ Negligible tendency to “stick-slip” effect, good sliding properties.
- ⇒ Low break-away load after long standstills.
- ⇒ Excellent gap extrusion resistance due to the free space on the trailing side

Application

Reciprocating pistons in hydraulic cylinders, plungers.
 Dynamic seals in hydraulic systems.
 Tandem arrangement possible.
 Max. pressure 400 bar, max. speed 15 m/s.

Installation

Snap-in installation.
 Attention: PTFE glide rings needs calibration after installation!

Tolerances	[mm]	
NL < 10mm	+ 0.2	
NL ≥ 10mm	+ 0.3	
∅ NA	H 8	
∅ NI	h 8	
Surface roughness	Rtmax [μ]	Ra [μ]
Bottom of groove	≤ 6.3	≤ 1.6
Face of groove	≤ 15	≤ 3
Sliding surface	Rtmax [μ]	Ra [μ]
PU, elastomer	≤ 2.5	≤ 0.1-0.5
PTFE	≤ 2	≤ 0.05-0.3

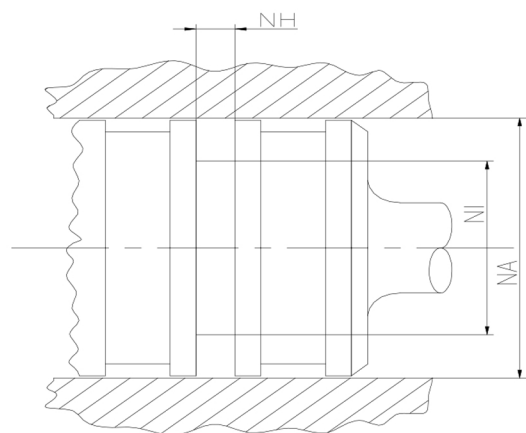

Sealco House, Maypole Fields Halesowen, West Midlands, UK, B63 2QB

T: (+44)1384 413058 E: sales@sealco.co.uk W: www.sealco.co.uk